



See More Online

KFB: Key Facts For Buyers

A Guide to This Property & the Local Area

Thursday 26th March 2026

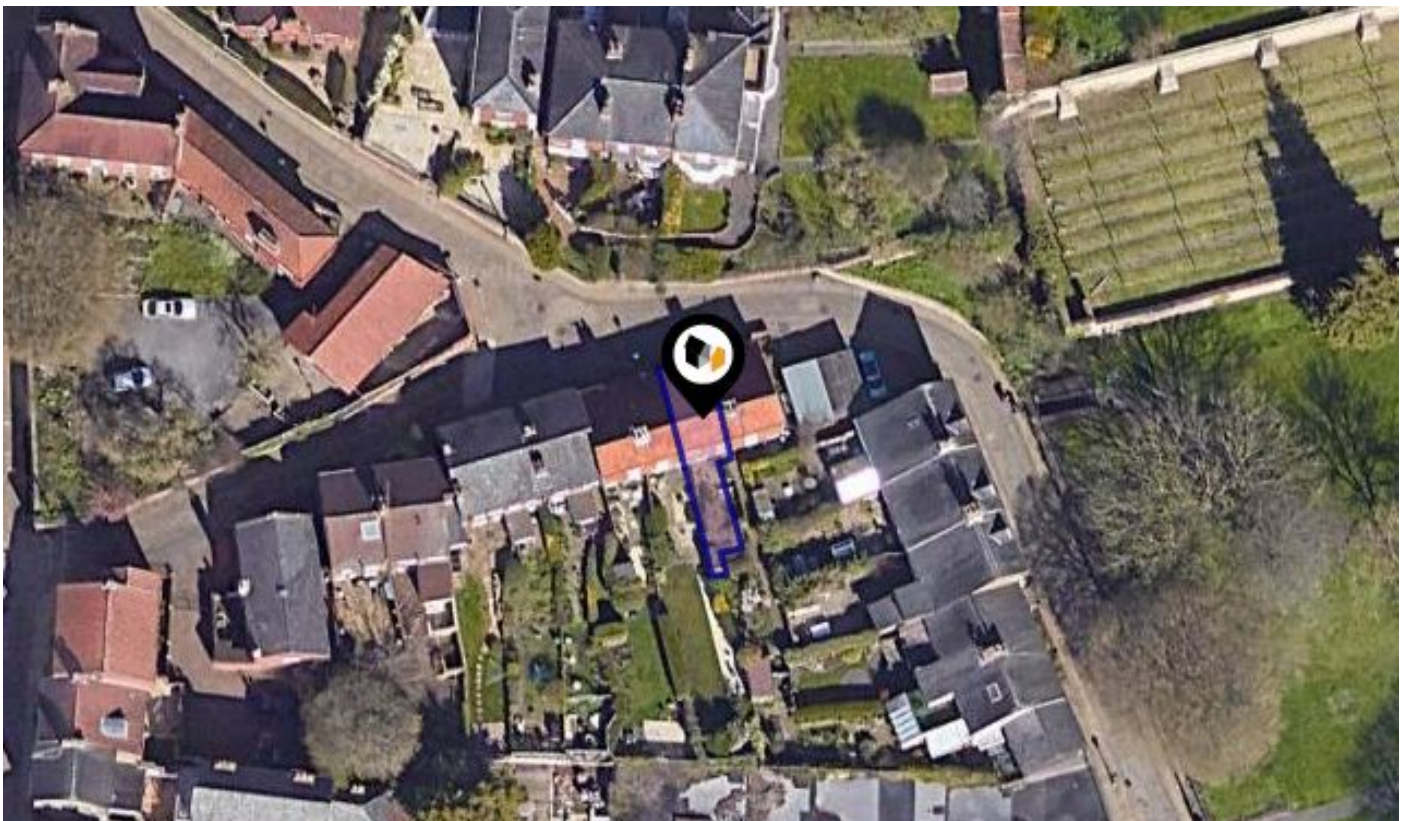

DANES COTTAGES, LINCOLN, LN2

Mundys

29 – 30 Silver Street Lincoln LN2 1AS

01522 510 044

amy.lee@mundys.net

www.mundys.net



Property Overview



Property

Type:	Terraced	Tenure:	Freehold
Bedrooms:	2		
Floor Area:	796 ft ² / 74 m ²		
Plot Area:	0.01 acres		
Council Tax :	Band B		
Annual Estimate:	£1,759		
Title Number:	LL275923		

Local Area

Local Authority:	Lincolnshire
Conservation Area:	Cathedral and City Centre

Flood Risk:	
● Rivers & Seas	Very low
● Surface Water	Very low

Estimated Broadband Speeds (Standard - Superfast - Ultrafast)

16 mb/s	74 mb/s	- mb/s

Mobile Coverage: (based on calls indoors)



Satellite/Fibre TV Availability:



Planning History

This Address

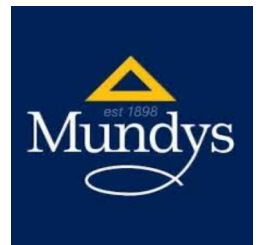

Planning records for: *Danes Cottages, Lincoln, LN2*

Reference - 2026/0102/LBC
Decision: Pending Consideration
Date: 18th February 2026
Description: Erection of fence and gate to rear garden. (Listed Building Consent).

Reference - 2025/0649/LBC
Decision: Decided
Date: 28th October 2025
Description: Internal alterations including installation of stud wall to form new shower room on second floor. (Listed Building Consent).

Gallery Photos

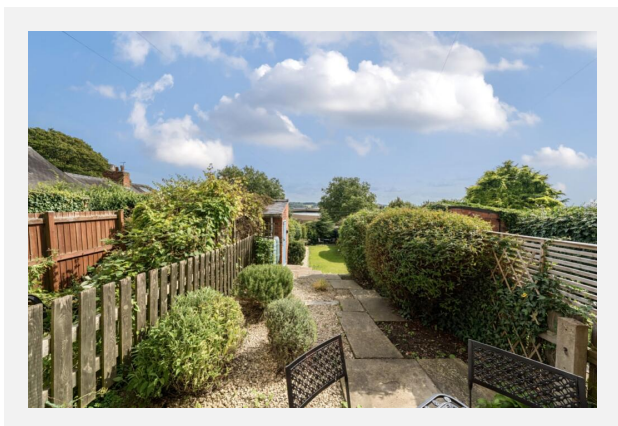
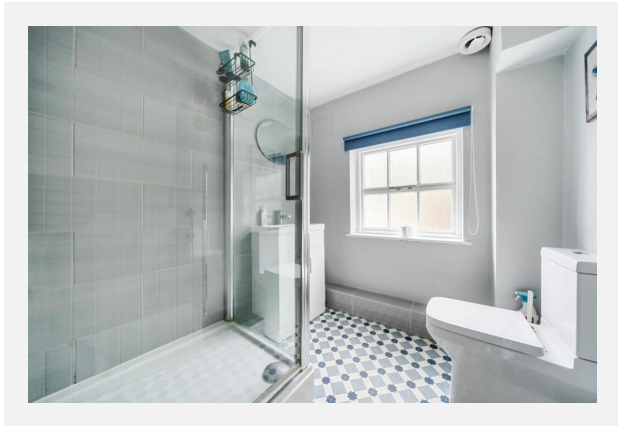

Gallery Photos



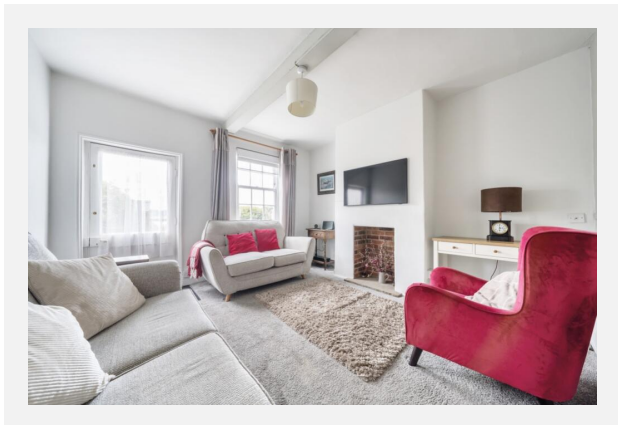
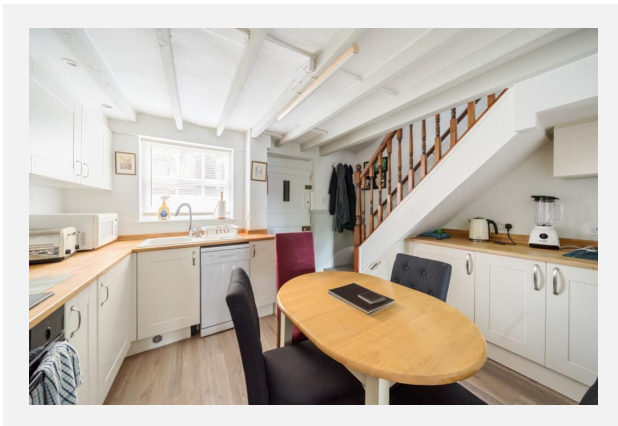

DANES COTTAGES, LINCOLN, LN2

Danes Cottages, LN2

Approximate Area = 778 sq ft / 72.3 sq m

For identification only - Not to scale

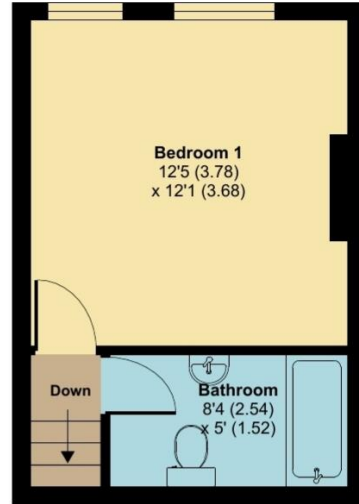

SECOND FLOOR

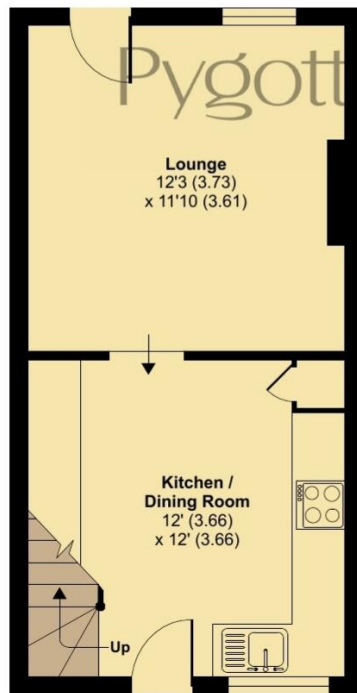

GROUND FLOOR

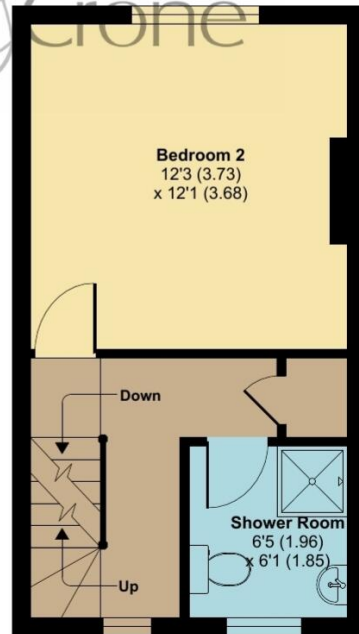

FIRST FLOOR



Floor plan produced in accordance with RICS Property Measurement Standards incorporating International Property Measurement Standards (IPMS2 Residential). © ncthecom 2023. Produced for Pygott & Crone. REF: 1019732

Property EPC - Certificate



LINCOLN, LN2

Energy rating

D

Valid until 02.02.2035

Score	Energy rating	Current	Potential
92+	A		
81-91	B		89 B
69-80	C		
55-68	D	58 D	
39-54	E		
21-38	F		
1-20	G		

Property

EPC - Additional Data

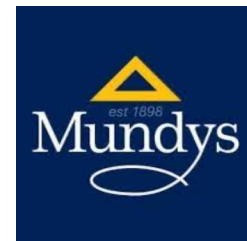

Additional EPC Data

Property Type:	Mid-terrace house
Walls:	Solid brick, as built, no insulation (assumed)
Walls Energy:	Very poor
Roof:	Pitched, no insulation (assumed)
Roof Energy:	Very poor
Window:	Partial secondary glazing
Window Energy:	Average
Main Heating:	Boiler and radiators, mains gas
Main Heating Energy:	Good
Main Heating Controls:	Programmer, room thermostat and TRVs
Main Heating Controls Energy:	Good
Hot Water System:	From main system
Hot Water Energy Efficiency:	Average
Lighting:	No low energy lighting
Lighting Energy:	Very poor
Floors:	Solid, no insulation (assumed)
Secondary Heating:	Room heaters, mains gas
Total Floor Area:	74 m ²

Market House Price Statistics



10 Year History of Average House Prices by Property Type in LN2

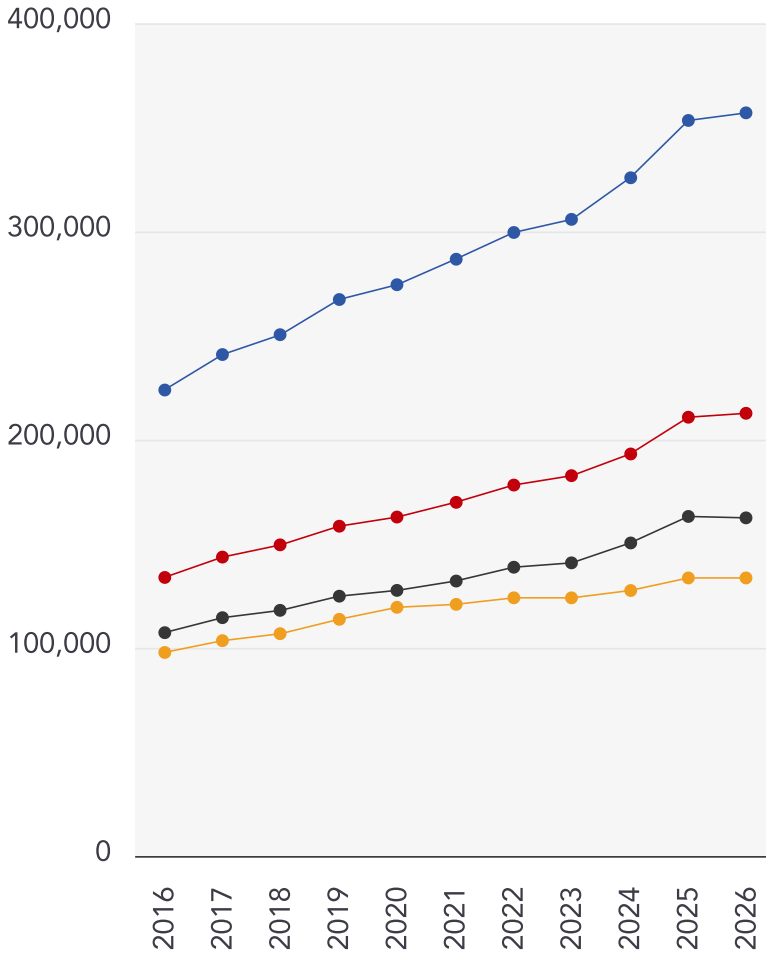

Detached

+59.47%

Semi-Detached

+58.92%

Terraced

+51.39%

Flat

+36.6%

Maps

Coal Mining



This map displays nearby coal mine entrances and their classifications.



Mine Entry

- ✕ Adit
- ✕ Gutter Pit
- ✕ Shaft

The Coal Authority has records of over 175,000 mine entries within the UK captured in the National Coal Mining database, derived from sources including abandonment plans, geological and topographical plans.

Coal mining activity is recorded as far back as the 13th century, but prior to 1872 there was no requirement to deposit abandonment plans. It is therefore believed there may be many unrecorded mine entries of which the Authority has no information or knowledge. These entries do not, therefore, appear within the Authority's national dataset as shown on this map.

Maps







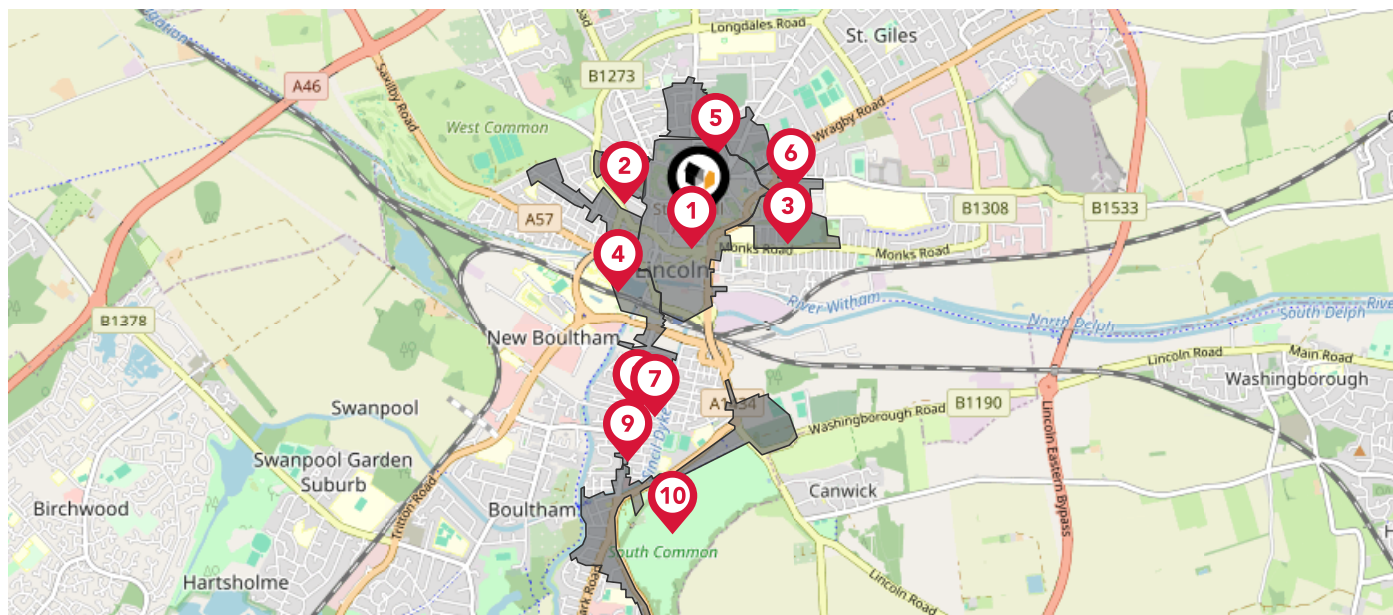



Conservation Areas



This map displays nearby official conservation areas. Every local authority in England has at least one conservation area. Most are designated by the Council as the local planning authority, though Historic England and the Secretary of State also have the power to create them.



Nearby Conservation Areas

-  1 Cathedral and City Centre
-  2 Carline
-  3 Lindum and Arboretum
-  4 West Parade and Brayford
-  5 Newport and Nettleham Road
-  6 The Dell
-  7 Sibthorp
-  8 St Peter-at-Gowts
-  9 Gowt's Bridge
-  10 St Catherines

Maps



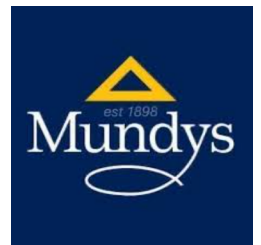



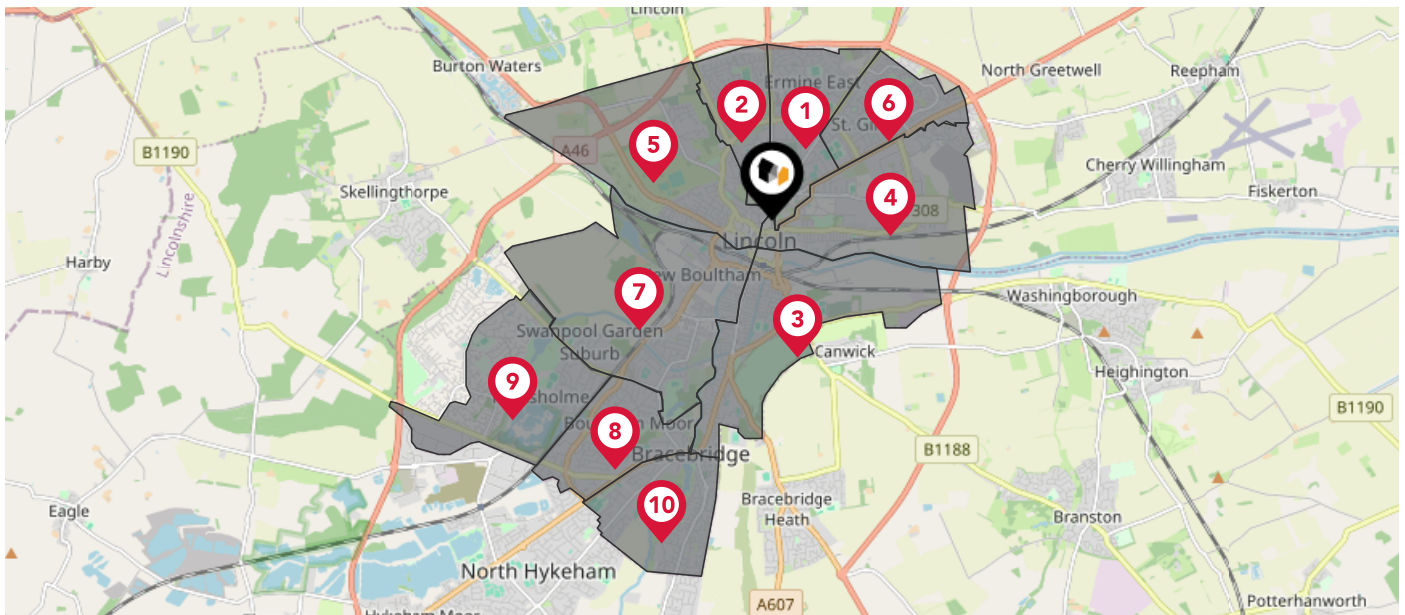



Council Wards



The UK is divided into wards that are used for local elections to elect local government councillors. Sometimes these are known as 'electoral divisions'. Population counts can vary substantially between wards, but the national average is about 5,500



Nearby Council Wards

-  1 Minster Ward
-  2 Castle Ward
-  3 Park Ward
-  4 Abbey Ward
-  5 Carholme Ward
-  6 Glebe Ward
-  7 Boutham Ward
-  8 Moorland Ward
-  9 Hartsholme Ward
-  10 Witham Ward

Maps Rail Noise



This map displays the noise levels from nearby network rail and HS1 railway routes that affect this property...

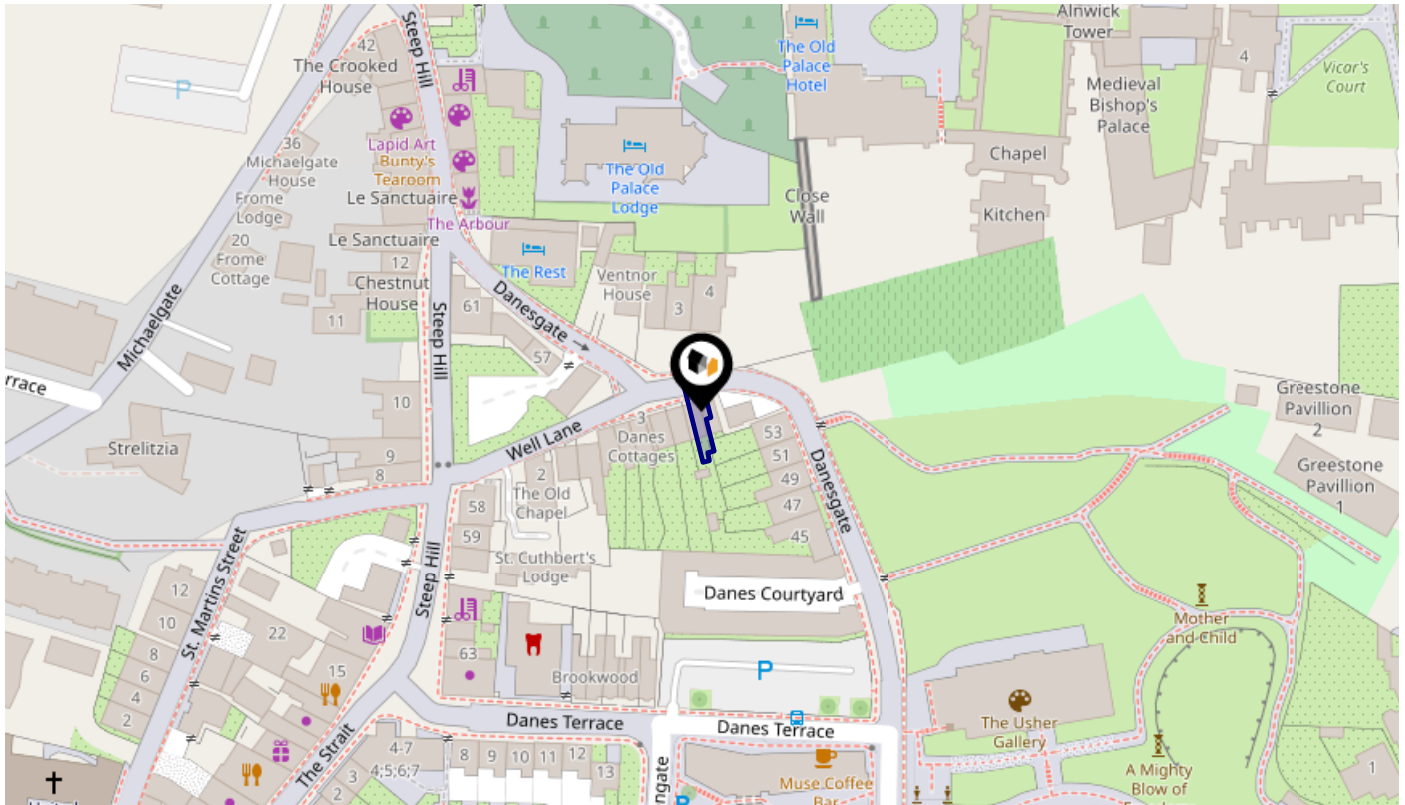

Rail Noise Data

This data indicates the level of noise according to the strategic noise mapping of rail sources within areas with a population of at least 100,000 people (agglomerations) and along Network Rail and HS1 traffic routes.

The data indicates the annual average noise levels for the 16-hour period between 0700 - 2300.

Noise levels are modelled on a 10m grid at a receptor height of 4m above ground, polygons are then produced by merging neighbouring cells within the following noise classes:

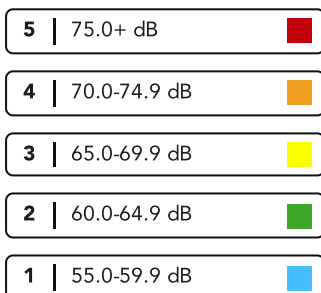

Flood Risk

Rivers & Seas - Flood Risk



This map shows the chance of flooding from rivers and / or the sea, taking into account flood defences and their condition.

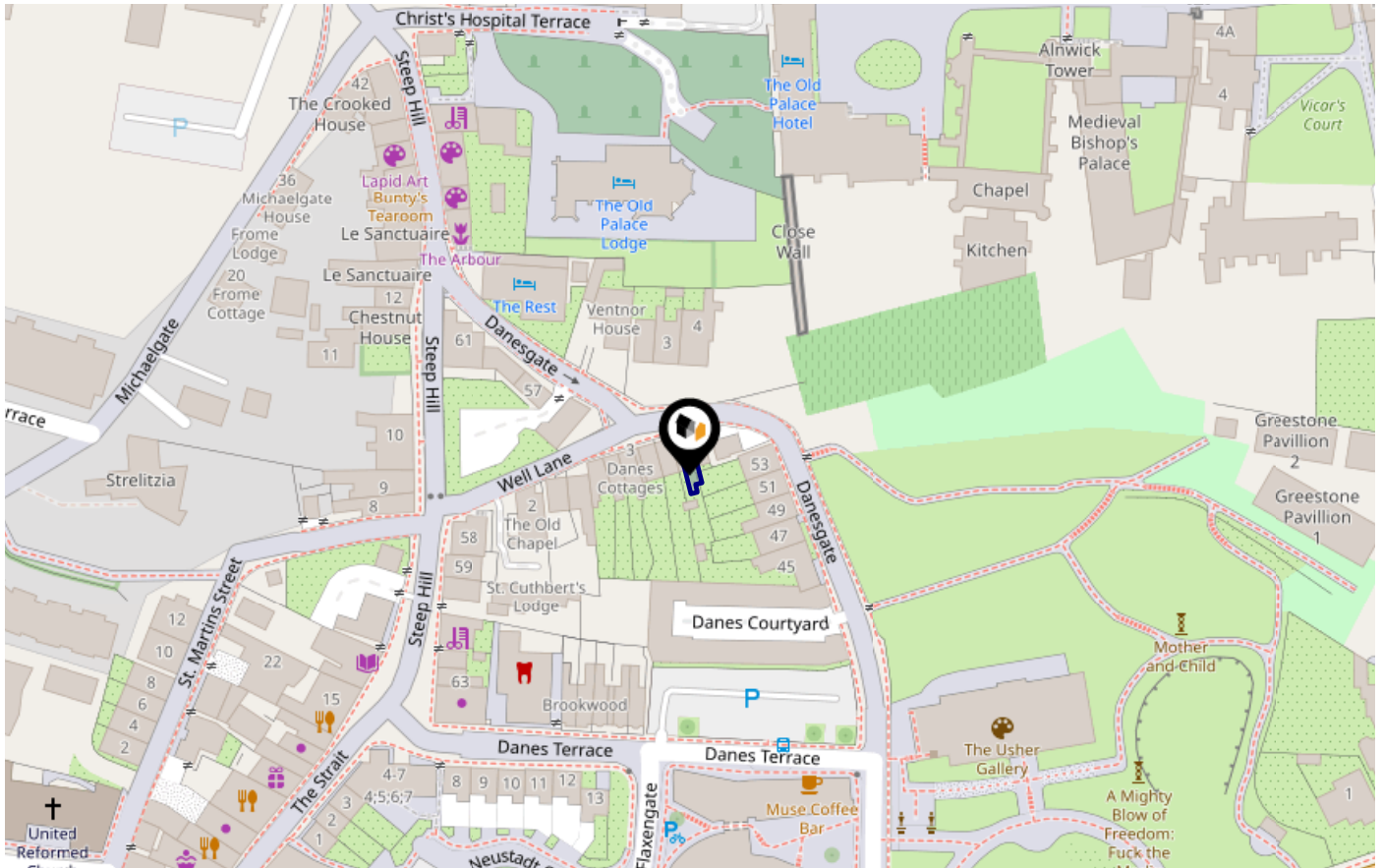

Risk Rating: Very low

The map does not contain sufficient information for it to be used to determine flood risk to individual properties, but it does give you an indication of whether your area may be affected by surface water flooding at this risk level.

- High Risk** - an area which has a chance of flooding of greater than 1 in 30 (3.3%) in any one year.
- Medium Risk** - an area which has a chance of flooding of greater than 1 in 100 (1.0%) in any one year.
- Low Risk** - an area which has a chance of flooding of greater than 1 in 1000 (0.1%) in any one year.
- Very Low Risk** - an area in which the risk is below 1 in 1000 (0.1%) in any one year.

Chance of flooding to the following depths at this property:



Flood Risk

Rivers & Seas - Climate Change



This map shows the future chance of flooding from rivers and / or the sea **between 2036 and 2069**, taking into account flood defences and their condition. The government climate change models cannot predict exactly when the chance of flooding will go up. It could happen at any time during the time period.

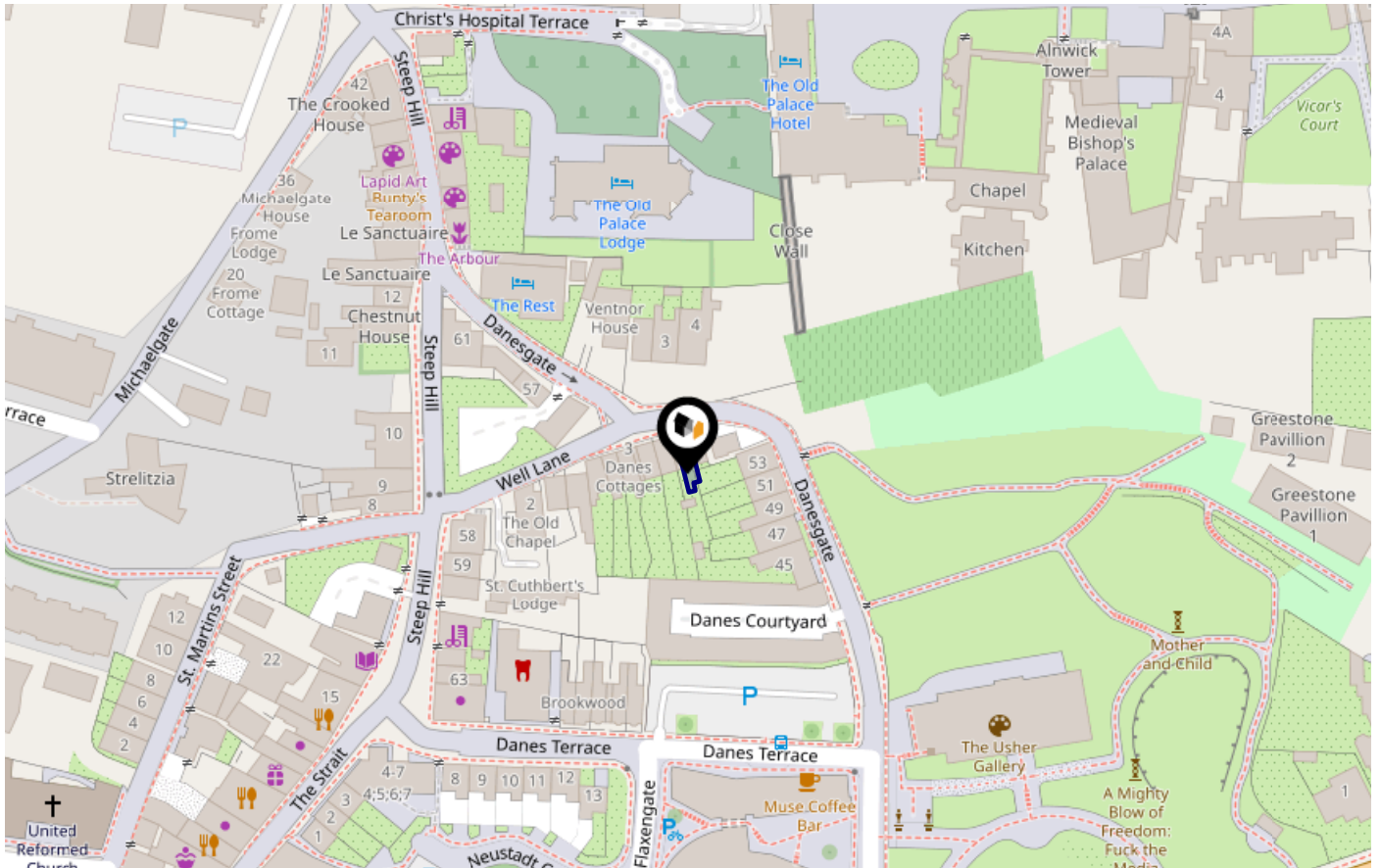

Risk Rating: Very low

The map does not contain sufficient information for it to be used to determine flood risk to individual properties, but it does give you an indication of whether your area may be affected by surface water flooding at this risk level.

- High Risk** - an area which has a chance of flooding of greater than 1 in 30 (3.3%) in any one year.
- Medium Risk** - an area which has a chance of flooding of greater than 1 in 100 (1.0%) in any one year.
- Low Risk** - an area which has a chance of flooding of greater than 1 in 1000 (0.1%) in any one year.
- Very Low Risk** - an area in which the risk is below 1 in 1000 (0.1%) in any one year.

Chance of flooding to the following depths at this property:



Flood Risk

Surface Water - Flood Risk



This map shows the chance of flooding where rainwater has nowhere to drain. This kind of flooding can occur far from rivers or seas.

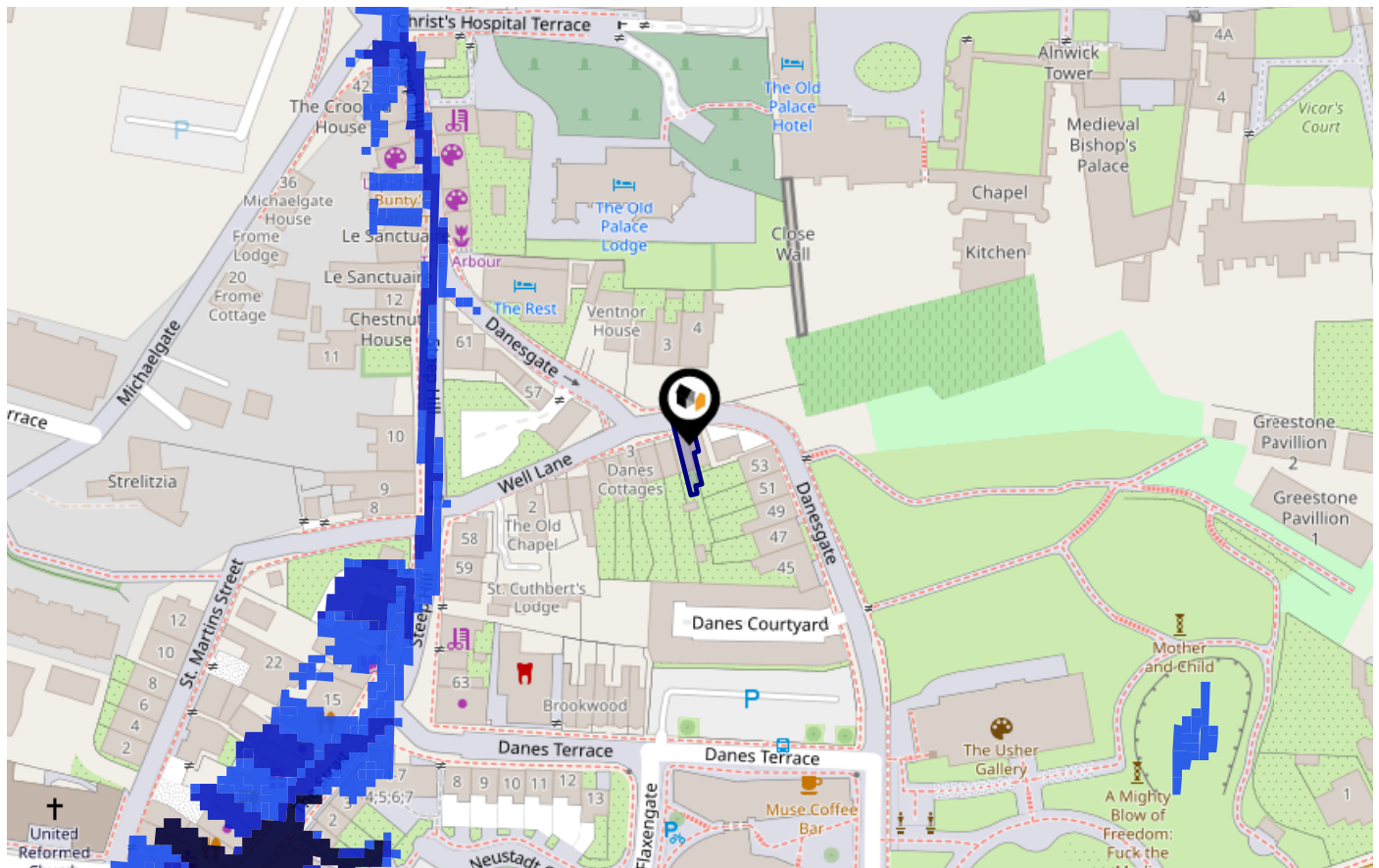

Risk Rating: Very low

The map does not contain sufficient information for it to be used to determine flood risk to individual properties, but it does give you an indication of whether your area may be affected by surface water flooding at this risk level.

- High Risk** - an area which has a chance of flooding of greater than 1 in 30 (3.3%) in any one year.
- Medium Risk** - an area which has a chance of flooding of greater than 1 in 100 (1.0%) in any one year.
- Low Risk** - an area which has a chance of flooding of greater than 1 in 1000 (0.1%) in any one year.
- Very Low Risk** - an area in which the risk is below 1 in 1000 (0.1%) in any one year.

Chance of flooding to the following depths at this property:



Flood Risk

Surface Water - Climate Change



This map shows the future chance of flooding **between 2040 and 2060** where rainwater has nowhere to drain. This kind of flooding can occur far from rivers or seas. The government climate change models cannot predict exactly when the chance of flooding will go up. It could happen at any time during the time period.

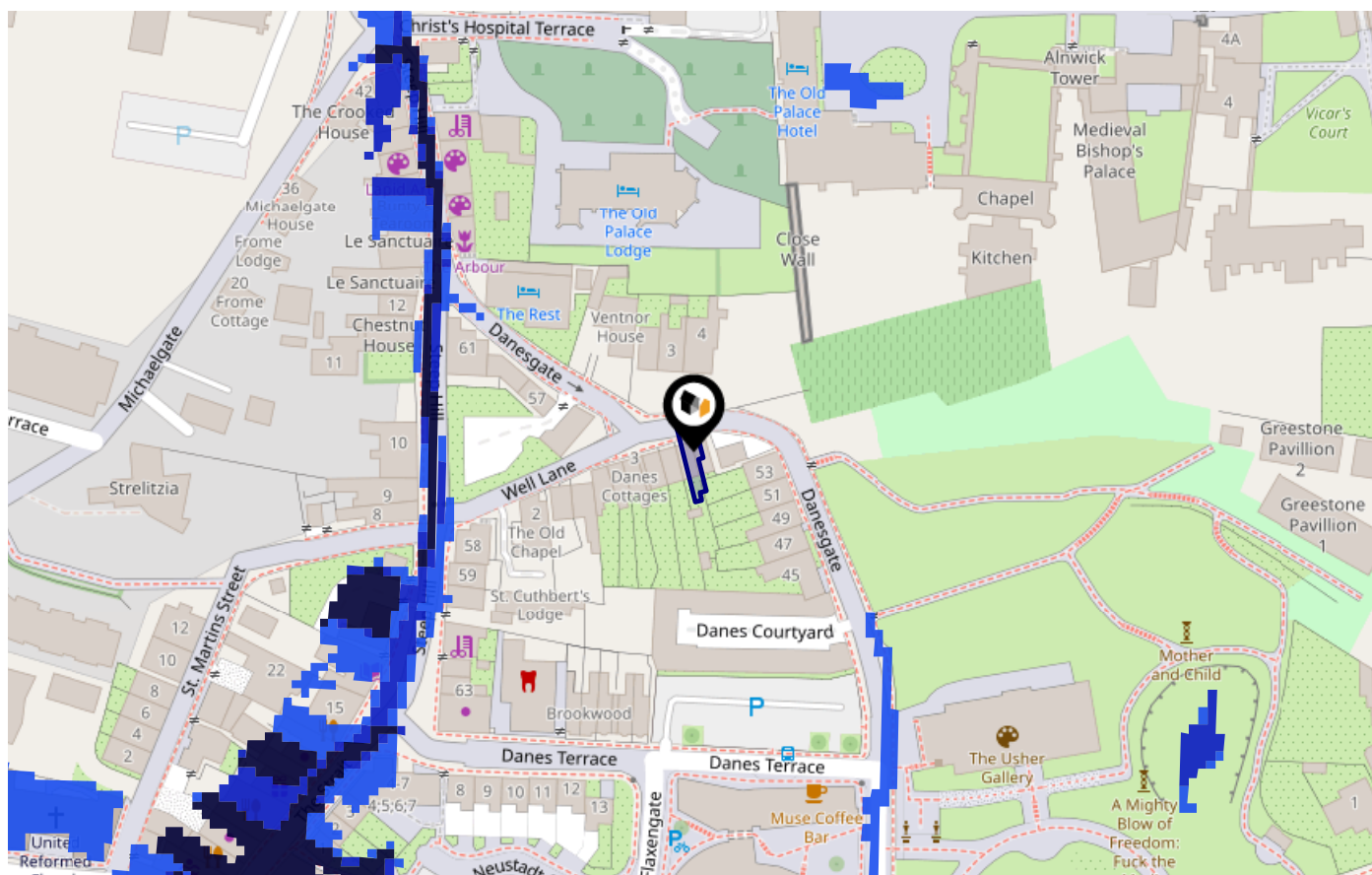

Risk Rating: Very low

The map does not contain sufficient information for it to be used to determine flood risk to individual properties, but it does give you an indication of whether your area may be affected by surface water flooding at this risk level.

- High Risk** - an area which has a chance of flooding of greater than 1 in 30 (3.3%) in any one year.
- Medium Risk** - an area which has a chance of flooding of greater than 1 in 100 (1.0%) in any one year.
- Low Risk** - an area which has a chance of flooding of greater than 1 in 1000 (0.1%) in any one year.
- Very Low Risk** - an area in which the risk is below 1 in 1000 (0.1%) in any one year.

Chance of flooding to the following depths at this property:

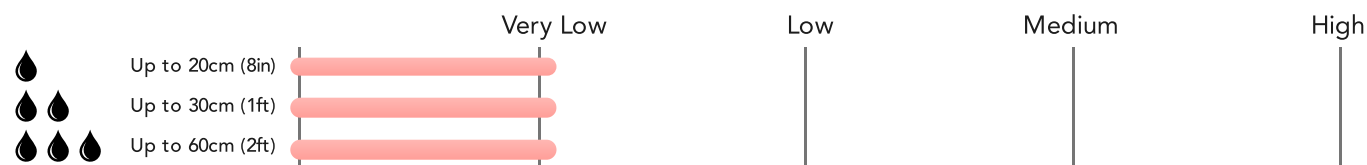

Maps Green Belt



This map displays nearby areas that have been designated as Green Belt...

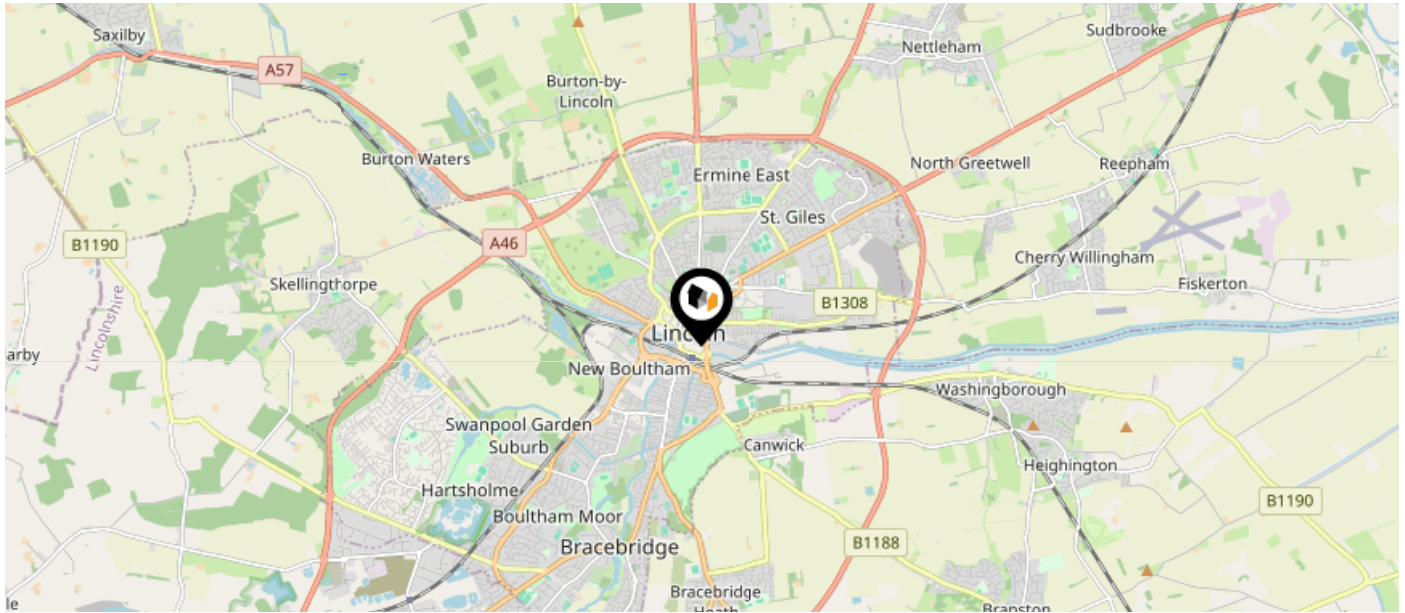

Nearby Green Belt Land

No data available.

Maps

Landfill Sites



This map displays the location of known landfill sites. Historic sites are where there is no environmental permit in force. Active sites are currently authorised by the Environment Agency under Environmental Permitting Regulations.

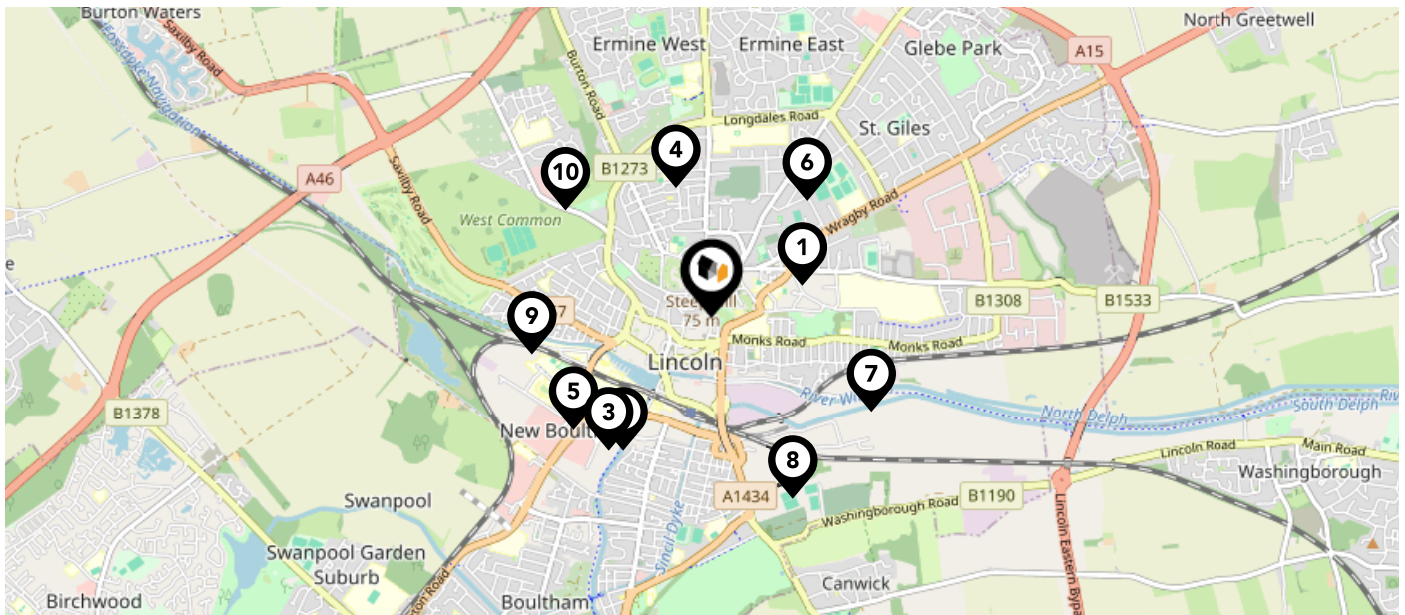

Nearby Landfill Sites

	The Dell-Wragby Road	Historic Landfill 
	Land South Of Ropewalk-Land South Of Ropewalk, Rear Of Mervyn Black	Historic Landfill 
	Former Brayford Leisure Site-Ropewalk	Historic Landfill 
	Mount Street-Lincoln, Lincolnshire	Historic Landfill 
	Rear Of British Rail Social Club-Ropewalk	Historic Landfill 
	Nursery Grove-Lincoln, Lincolnshire	Historic Landfill 
	East Of Power Station Site-Spa Road	Historic Landfill 
	East Of Dunford Road-Cow Paddle, Lincoln	Historic Landfill 
	Former Fisons Site-Carholme Road	Historic Landfill 
	EA/EPR/BP3598NX/A001 - Serviceteam Ltd	Active Landfill 









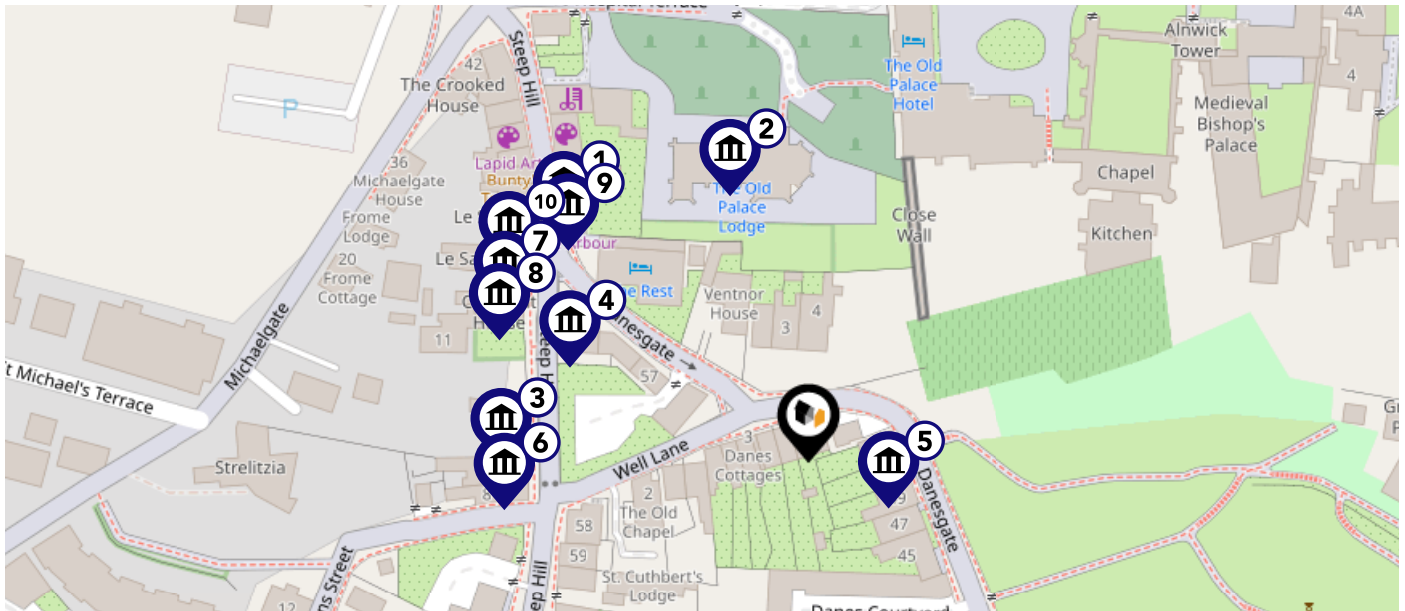

Maps

Listed Buildings



This map displays nearby listed buildings and protected structures, as well as their listed tier and distance from the target property...







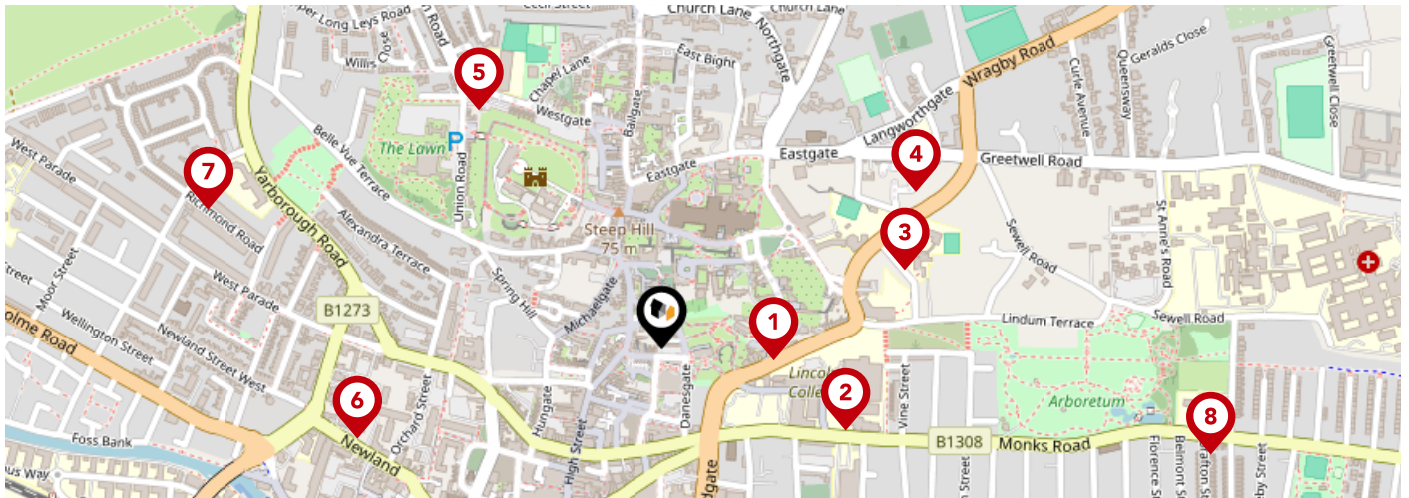

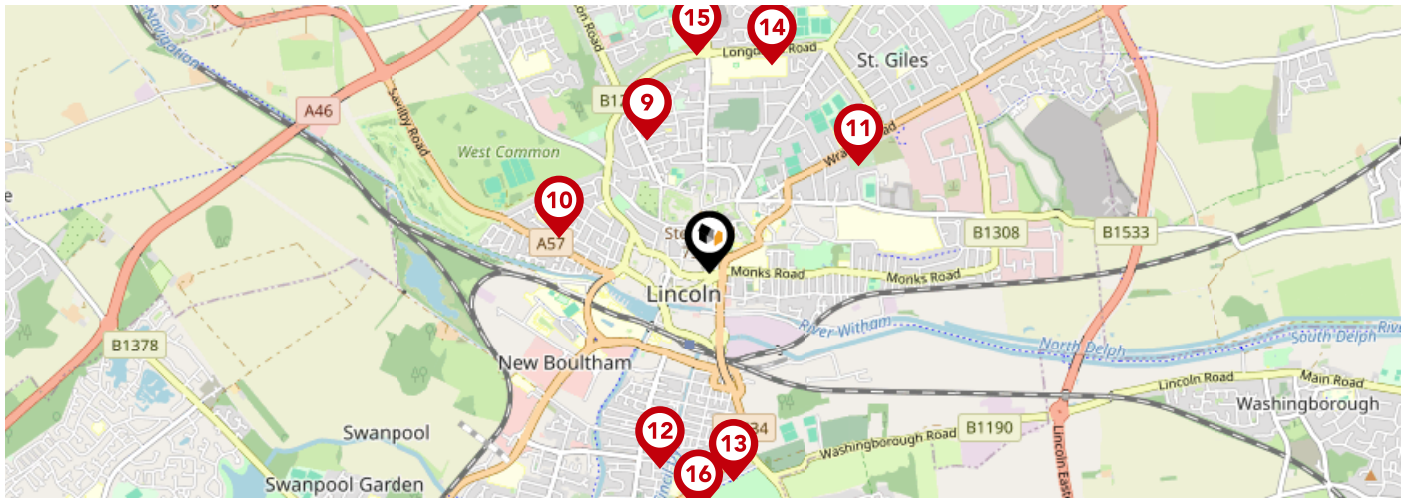

Listed Buildings in the local district	Grade	Distance
 1388798 - Harding House	Grade II	0.0 miles
 1388497 - Church Of St Michael On The Mount	Grade II	0.0 miles
 1388771 - 10, Steep Hill	Grade II	0.0 miles
 1388504 - Steep Hill House	Grade II	0.0 miles
 1388503 - 49, 51 And 53, Danesgate	Grade II	0.0 miles
 1388770 - 9, Steep Hill	Grade II	0.0 miles
 1388773 - 12 And 13, Steep Hill	Grade II	0.0 miles
 1388772 - Chestnut House	Grade II	0.0 miles
 1388799 - 52 And 53, Steep Hill	Grade II	0.0 miles
 1388774 - 14, Steep Hill	Grade II	0.0 miles

Area Schools



		Nursery	Primary	Secondary	College	Private
1	Lincoln UTC Ofsted Rating: Good Pupils: 369 Distance:0.12	<input type="checkbox"/>	<input type="checkbox"/>	<input checked="" type="checkbox"/>	<input type="checkbox"/>	<input type="checkbox"/>
2	Lincoln College Ofsted Rating: Good Pupils:0 Distance:0.22	<input type="checkbox"/>	<input type="checkbox"/>	<input checked="" type="checkbox"/>	<input type="checkbox"/>	<input type="checkbox"/>
3	Lincoln Minster School Ofsted Rating: Not Rated Pupils: 473 Distance:0.28	<input type="checkbox"/>	<input type="checkbox"/>	<input checked="" type="checkbox"/>	<input type="checkbox"/>	<input type="checkbox"/>
4	The Lincoln St Peter-in-Eastgate Church of England (Controlled) Infants School Ofsted Rating: Requires improvement Pupils: 89 Distance:0.33	<input type="checkbox"/>	<input checked="" type="checkbox"/>	<input type="checkbox"/>	<input type="checkbox"/>	<input type="checkbox"/>
5	Westgate Academy Ofsted Rating: Good Pupils: 430 Distance:0.33	<input type="checkbox"/>	<input checked="" type="checkbox"/>	<input type="checkbox"/>	<input type="checkbox"/>	<input type="checkbox"/>
6	Lincolnshire Secure Unit Ofsted Rating: Not Rated Pupils:0 Distance:0.35	<input type="checkbox"/>	<input type="checkbox"/>	<input checked="" type="checkbox"/>	<input type="checkbox"/>	<input type="checkbox"/>
7	The St Faith and St Martin Church of England Junior School, Lincoln Ofsted Rating: Good Pupils: 345 Distance:0.53	<input type="checkbox"/>	<input checked="" type="checkbox"/>	<input type="checkbox"/>	<input type="checkbox"/>	<input type="checkbox"/>
8	Lincoln Monks Abbey Primary School Ofsted Rating: Good Pupils: 594 Distance:0.62	<input type="checkbox"/>	<input checked="" type="checkbox"/>	<input type="checkbox"/>	<input type="checkbox"/>	<input type="checkbox"/>



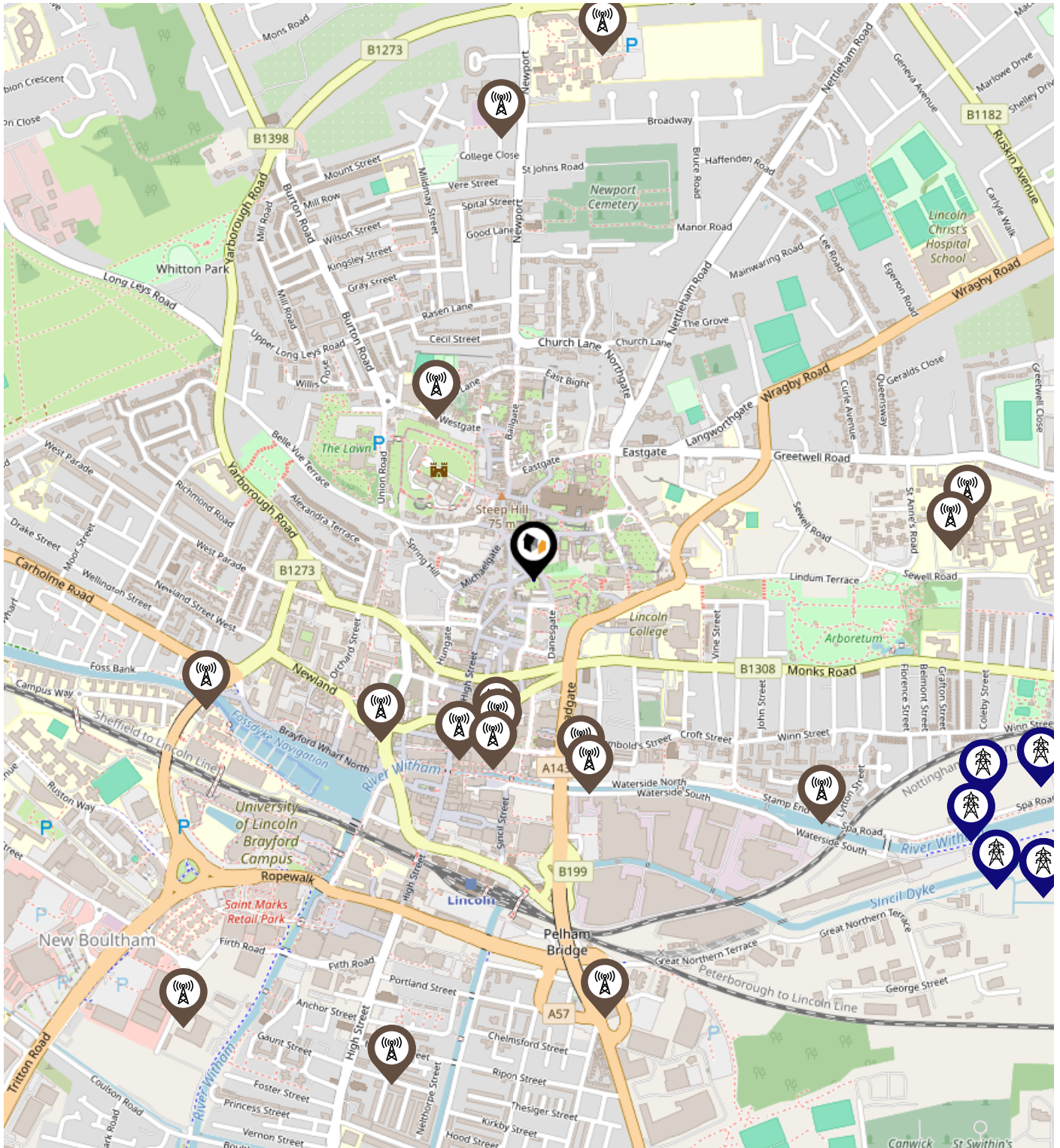

		Nursery	Primary	Secondary	College	Private
	Mount Street Academy Ofsted Rating: Outstanding Pupils: 318 Distance:0.65	<input type="checkbox"/>	<input checked="" type="checkbox"/>	<input type="checkbox"/>	<input type="checkbox"/>	<input type="checkbox"/>
	The St Faith's Church of England Infant and Nursery School, Lincoln Ofsted Rating: Good Pupils: 278 Distance:0.69	<input type="checkbox"/>	<input checked="" type="checkbox"/>	<input type="checkbox"/>	<input type="checkbox"/>	<input type="checkbox"/>
	Lincoln Christ's Hospital School Ofsted Rating: Good Pupils: 1286 Distance:0.81	<input type="checkbox"/>	<input type="checkbox"/>	<input checked="" type="checkbox"/>	<input type="checkbox"/>	<input type="checkbox"/>
	The Lincoln St Peter at Gowts Church of England Primary School Ofsted Rating: Outstanding Pupils: 258 Distance:0.89	<input type="checkbox"/>	<input checked="" type="checkbox"/>	<input type="checkbox"/>	<input type="checkbox"/>	<input type="checkbox"/>
	The Lincoln Bishop King Church of England Primary School Ofsted Rating: Good Pupils: 459 Distance:0.93	<input type="checkbox"/>	<input checked="" type="checkbox"/>	<input type="checkbox"/>	<input type="checkbox"/>	<input type="checkbox"/>
	Castles Education Ofsted Rating: Inadequate Pupils: 93 Distance:0.96	<input type="checkbox"/>	<input type="checkbox"/>	<input checked="" type="checkbox"/>	<input type="checkbox"/>	<input type="checkbox"/>
	Lincoln Castle Academy Ofsted Rating: Not Rated Pupils: 680 Distance:0.97	<input type="checkbox"/>	<input type="checkbox"/>	<input checked="" type="checkbox"/>	<input type="checkbox"/>	<input type="checkbox"/>
	Athena School Ofsted Rating: Good Pupils: 113 Distance:1.06	<input type="checkbox"/>	<input type="checkbox"/>	<input checked="" type="checkbox"/>	<input type="checkbox"/>	<input type="checkbox"/>

Local Area Masts & Pylons



Key:

-  Power Pylons
-  Communication Masts

Environment

Radon Gas



What is Radon?

Radon is a natural radioactive gas, which enters buildings from the ground. Exposure to high concentrations increases the risk of lung cancer. The UK Health Security Agency (UKHSA) recommends that radon levels should be reduced in homes where the annual average is at or above 200 becquerels per cubic metre (200 Bq/m³).

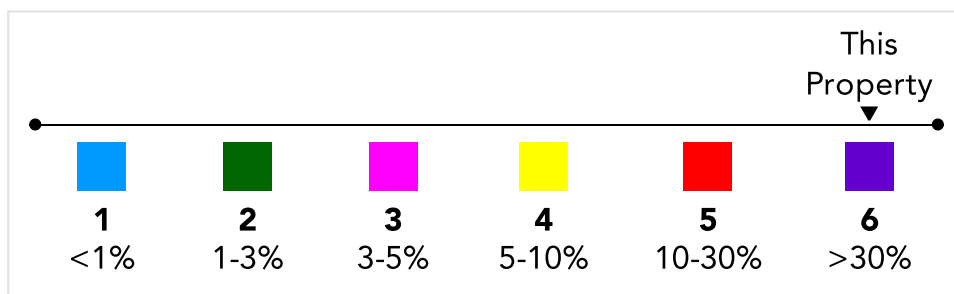
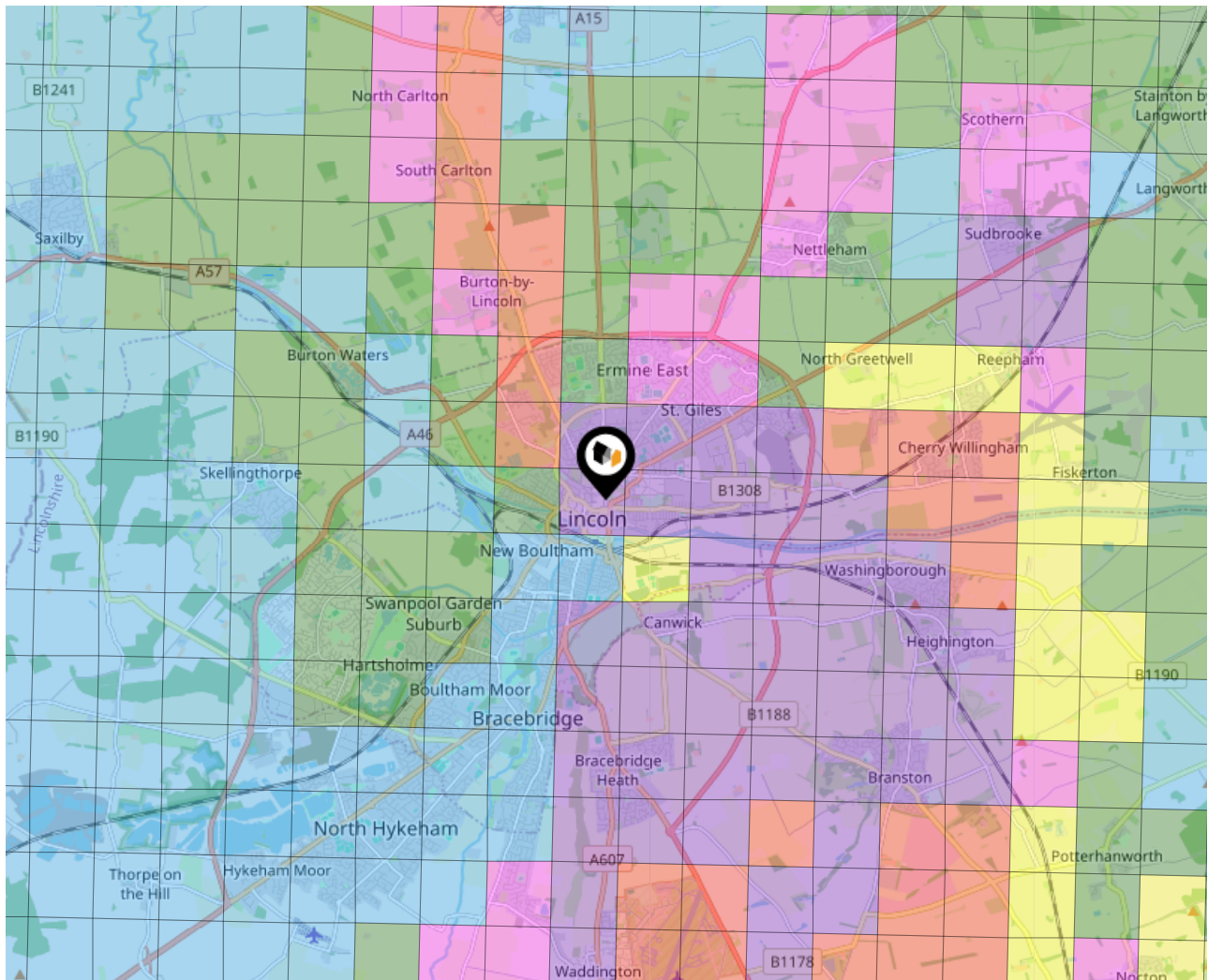

Local Area Road Noise

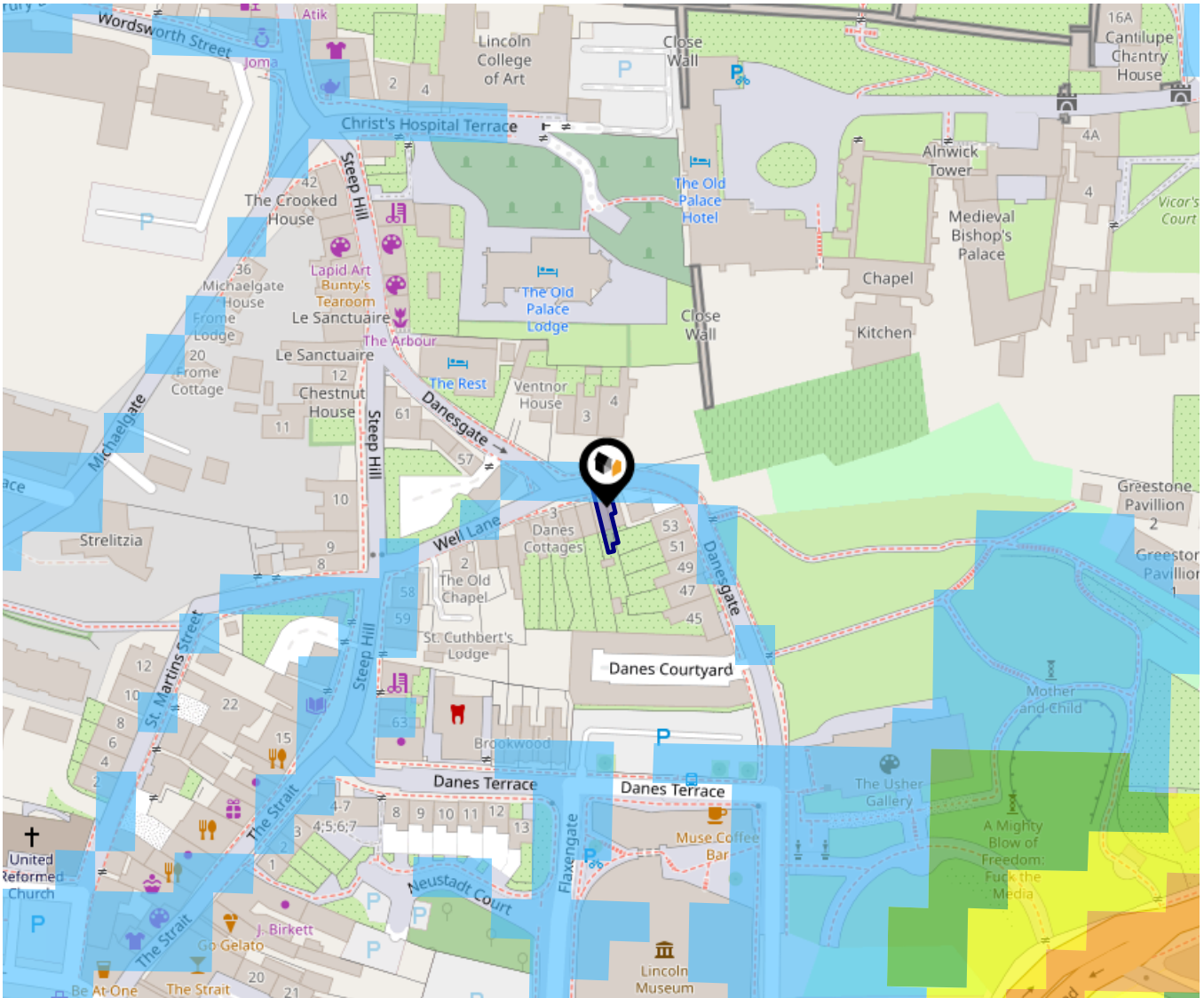

The data indicates the level of noise according to strategic noise sources across all traffic routes. This indicates a 25 house annual average noise level with separate weightings for the evening and the night periods.

- 75.0+ dB
- 70.0-74.9 dB
- 65.0-69.9 dB
- 60.0-64.9 dB
- 55.0-59.9 dB

Ground Composition for this Address (Surrounding square kilometer zone around property)

Carbon Content:	NONE	Soil Texture:	CLAY TO SANDY LOAM
Parent Material Grain:	ARGILLIC - ARENACEOUS	Soil Depth:	DEEP
Soil Group:	ALL		

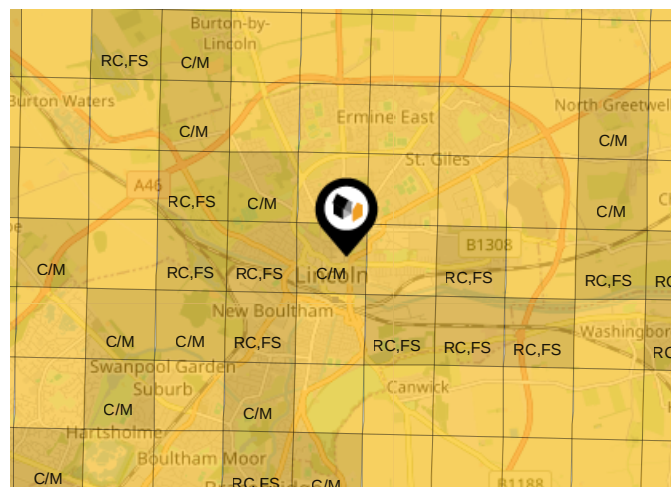

Primary Classifications (Most Common Clay Types)

C/M	Claystone / Mudstone
FPC,S	Floodplain Clay, Sand / Gravel
FC,S	Fluvial Clays & Silts
FC,S,G	Fluvial Clays, Silts, Sands & Gravel
PM/EC	Prequaternary Marine / Estuarine Clay / Silt
QM/EC	Quaternary Marine / Estuarine Clay / Silt
RC	Residual Clay
RC/LL	Residual Clay & Loamy Loess
RC,S	River Clay & Silt
RC,FS	Riverine Clay & Floodplain Sands and Gravel
RC,FL	Riverine Clay & Fluvial Sands and Gravel
TC	Terrace Clay
TC/LL	Terrace Clay & Loamy Loess

Area Transport (National)

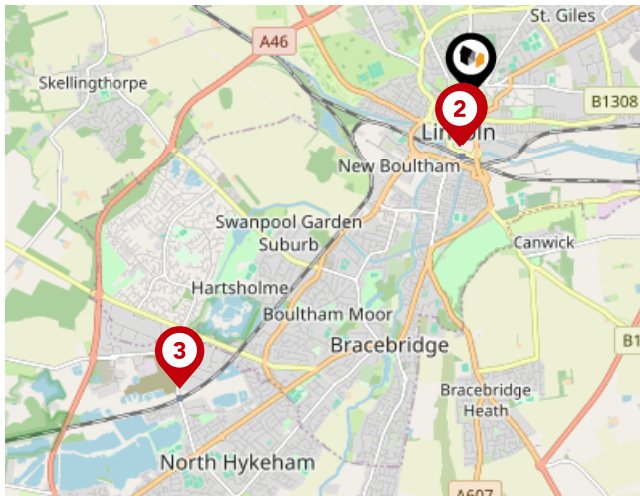
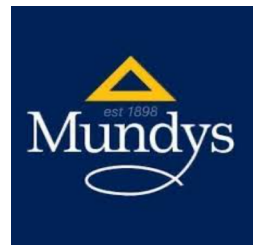

National Rail Stations

Pin	Name	Distance
1	Lincoln Central Rail Station	0.45 miles
2	Lincoln Central Rail Station	0.47 miles
3	Hykeham Rail Station	3.67 miles

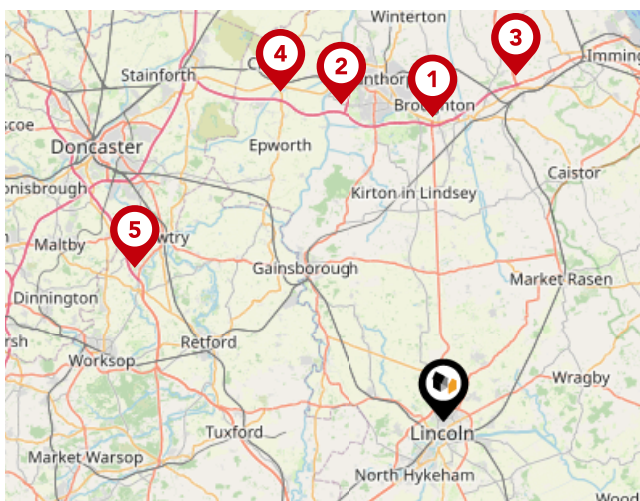

Trunk Roads/Motorways

Pin	Name	Distance
1	M180 J4	21.57 miles
2	M180 J3	23.61 miles
3	M180 J5	24.92 miles
4	M180 J2	26.02 miles
5	A1(M) J34	24.48 miles



Airports/Helipads

Pin	Name	Distance
1	Humberside Airport	25.48 miles
2	Finningley	26 miles
3	East Mids Airport	43.3 miles
4	Leeds Bradford Airport	63.75 miles

Area

Transport (Local)

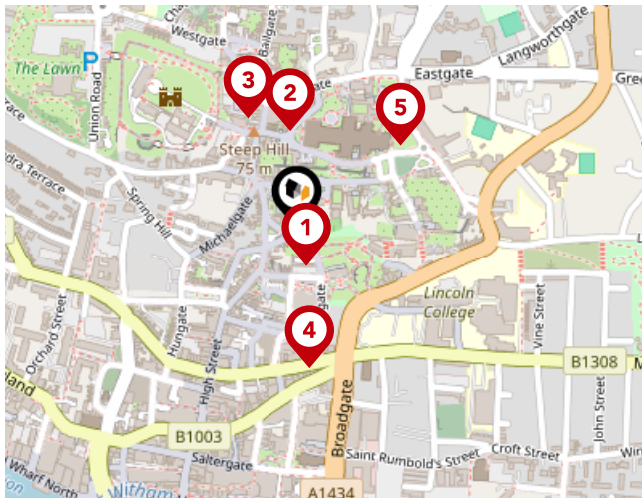

Bus Stops/Stations

Pin	Name	Distance
1	The Collection	0.04 miles
2	Cathedral	0.11 miles
3	Tourist Information Centre	0.13 miles
4	Constitutional Club	0.16 miles
5	Cathedral	0.15 miles



Mundys

We are dedicated to offering our customers the highest quality service and strongly believe in helping you through the entire process from start to finish. We believe the combination of qualified Partners, highly trained and experienced staff, unique understanding of the Newark, Southwell and Lincoln property markets and our commitment to the latest technology offers you the best Estate Agency in the area. Our offices are located on Kirkgate, Newark, King Street, Southwell, Silver Street and Museum Court, Lincoln also Queen Street, Market Rasen. We are one of the very few Agents in Newark, Southwell & Lincoln to be regulated by the Royal Institute of Chartered Surveyors.

We are dedicated to offering our customers the highest quality service and we strongly believe in helping you through the entire process from start to finish:

- Residential Sales
- Survey

Financial Services

We are pleased to offer the services of our Specialist Mortgage Advisors at Mundys Financial Services. Mundys Financial Services have extensive experience in the mortgage industry and provide independent whole of market advice from our offices based in Lincoln and Market Rasen.



Testimonial 1



Mundys have been wonderful. We will recommend them to anyone thinking of moving
- MR AND MRS GHEST

Testimonial 2



A huge thank you to you Emily and all of the Lettings Team for all your hard work in re-letting my apartment.
Please pass on my regards and thanks to all.
Again another superb performance from Mundys
MR FAHEY

Testimonial 3



Very satisfied with survey and would use again. I was impressed with how the Surveyor also telephoned me
to run through his report with me.
MRS HARDWICKE



/Mundysuk



/mundysuk



/mundysuk

Mundys

Data Quality

We are committed to comprehensive property data being made available upfront to make the home buying and selling process quicker, easier and cheaper. This is why we have partnered with Sprift, the UK's leading supplier of property-specific data.



Contains public sector information licensed under the Open Government License v3.0

The information contained within this report is for general information purposes only.

Sprift Technologies Ltd aggregate this data from a wide variety of sources and while we endeavour to keep the information up to date and correct, we make no representations or warranties of any kind, express or implied, about the completeness, accuracy, reliability, of the information or related graphics contained within this report for any purpose.

Any reliance you place on such information is therefore strictly at your own risk. In no event will we be liable for any loss or damage including without limitation, indirect or consequential loss or damage, or any loss or damage whatsoever arising from loss of data or profits arising out of, or in connection with, the use of this report.



Mundys

29 – 30 Silver Street Lincoln LN2 1AS

01522 510 044

amy.lee@mundys.net

www.mundys.net

